

The bloomice BODY ADYNA SW-185 185MHz is a compact robust versatile body mounted antenna designed for use in challenging environments and providing excellent performance.

The PCB copper antenna element is embedded within a rugged ABS / Zamak housing and integrated with a flexible 71mm helically wound, vertically polarised whip to provide excellent omni-directional coverage.

The antenna is fixed in to position with an M14 thread & nut which ensures a solid electrical and mechanical connection.

The bloomice BODY ADYNA SW-185 antenna is perfectly suited for use within the Smart Metering, PMR, PMR Digital and Asset Tracking industries and indeed in any external environment where solid reliability coupled with excellent performance is essential.

PRODUCT OVERVIEW

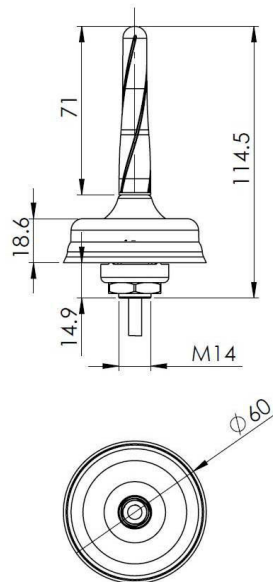

CAD DRAWING

VHF

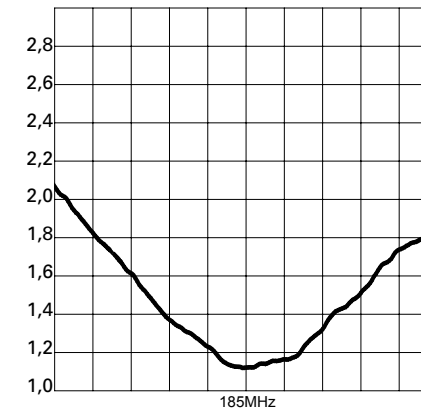

TYPICAL VSWR



PRODUCT PICTURE

Polarisation	Vertical
Frequency / Bandwidth	175MHz - 190MHz CENTRED AT 185MHz
VSWR	<1.5:1
Impedance	50Ω
Max. Input Power	60w
Gain	2.14dBi

Physical Characteristics	
Protection	IP67
Net Weight	167g
Operational Temperature	-45°c to +75°c
Humidity	100% @ 25°c
Connector	According to customer specification
Cable Type / Length	RG58 / According to customer specification
Material / Colour	ABS (Cover), Zamak (Base), TPE (Whip) / Black

TECHNICAL DATA

VHF

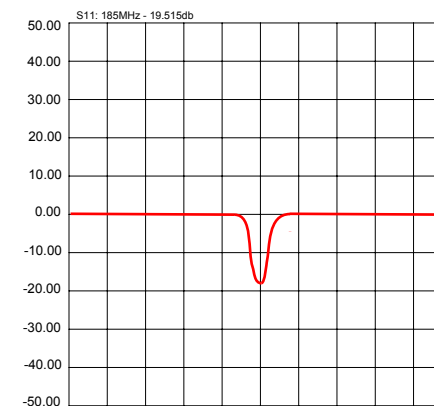

LOG MAG REPORT - TESTED WITH 300MM RG58